

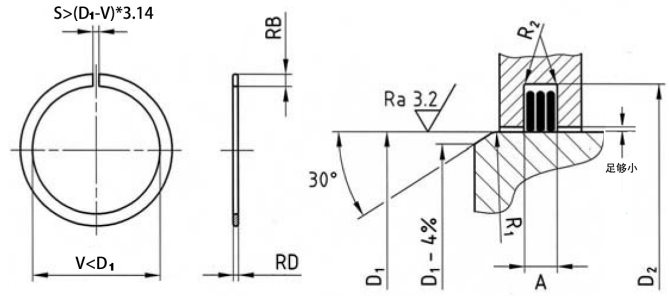

**LS**  
TYPE

密封叠环 FK 3 IS  
Sealing Rings



轴径 (mm)	公差	叠环 (mm)				凹槽尺寸 (mm)					
		RB	公差	RD	公差	D2=D1 MINUS	公差	A	公差	R1	R2
15-24.9		1.00		0.65		-2.60		2.20			
25-29.9		1.20		0.65		-3.00		2.20			
30-35.9		1.50		0.65		-3.60		2.20			
36-42.9		1.80		0.65		-4.20		2.20			
43-48.9		2.20		0.72		-5.00		2.40			
49-51.9		2.40		0.72		-5.40		2.40			
52-59.9	H6H7	2.60	+0.1/-0.1	0.72	+0.04/-0.02	-5.80	+0.2/-0	2.40	+0.1/-0	min.1	0.10
60-69.9		2.80		0.82		-6.20		2.70			
70-74.9		3.10		0.82		-6.80		2.70			
75-79.9		3.30		0.82		-7.20		2.70			
80-89.9		3.50		0.82		-7.60		2.70			
90-99.9		3.80		0.82		-8.20		2.70			
100-104.9		4.10		0.82		-8.80		2.70			
105-109.9		4.30		0.98		-9.20		3.30			
110-119.9	H7H8	4.60	+0.1/-0.2	0.98	+0.05/-0.03	-9.80	+0.25/-0	3.30	+0.15/-0	min.2	0.20
120-129.9		5.00		0.98		-10.80		3.30			
130-149.9		5.50		0.98		-11.80		3.30			
150-170.9		6.00		1.00		-13.00		3.40			
150-170.9		6.00		1.50		-13.00		5.10			
171-199.9		7.00		1.00		-15.00		3.40			
171-199.9		7.00		1.50		-15.00		5.10			
200-259.9	H8H9	8.00	+0.15/-0.3	1.20	+0.06/-0.04	-18.00	+0.3/-0	4.10	+0.2/-0	min.3	0.30
200-259.9		8.00		1.50		-18.00		5.10			
260-319.9		9.00		1.50		-20.00		5.10			
320-399.9		10.00		1.50		-22.00		5.20			
400-439.9		11.00		1.50		-24.00		5.20			
440-600.9		12.00		1.50		-26.00		5.20			
440-600.9		12.00		2.50		-26.00		8.30			
601-699.9		14.00		2.50		-32.00		8.30			
700-799.9	H9H10	16.00	+0.2/-0.4	2.50	+0.07/-0.05	-36.00	+0.4/-0	8.30	+0.25/-0	min.4	0.40
800-899.9		18.00		2.50		-40.00		8.30			
900-999.9		20.00		2.50		-44.00		8.30			
1000-1300.0		22.00		2.50		-48.00		8.40			